

boltswitch[®]

CLASS 1 GROUND FAULT RELAYS



	CATALOG NUMBERS	
	WITHOUT INTERLOCK	WITH INTERLOCK
GROUND FAULT RELAY	GFR-1	GFR-2
PANEL MOUNTING KIT (IF REQUIRED)	GFRK-1	GFRK-2

APPLICATION: These relays are designed primarily for installation on main service disconnects as required by the National Electric Code, Article 230.95. They are used in conjunction with Boltswitch Ground Fault Sensors. Models are available with and without zone interlock circuitry. With zone interlock, the time delay only functions when a downstream device is also sensing a fault.

TESTS: Tested in accordance with UL1053 and listed as Ground Fault Sensing and Relaying Equipment.

FEATURES: Very compact design, adjustable pick-up, adjustable time delay, control power indicator light, trip indicator, ground fault indicator level light bar, built in test feature, base or panel mountable, clear protective cover.

Instructions and wiring diagrams can be found in Bulletin 108, Rev. 6 on our web site in the support section.

boltswitch[®], ***inc.***

6208 COMMERCIAL ROAD CRYSTAL LAKE, ILLINOIS 60014

www.boltswitch.com

AUGUST, 2019

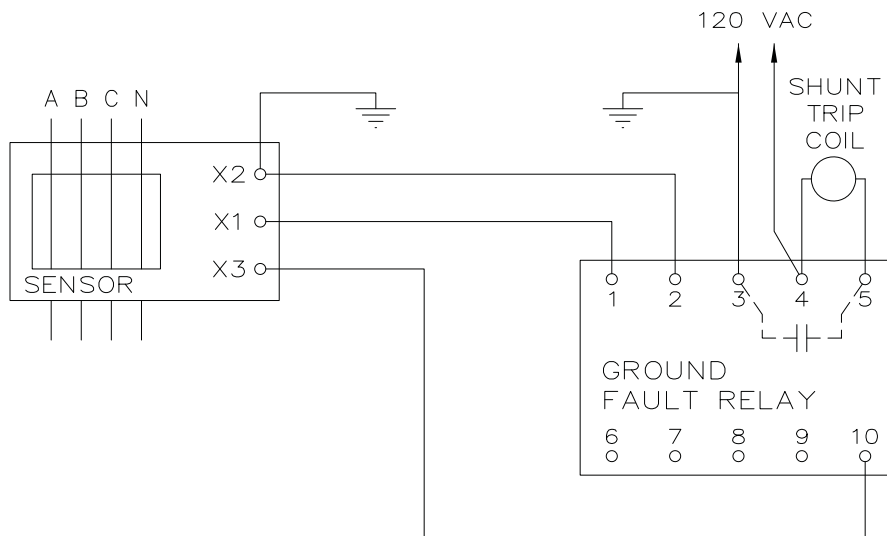
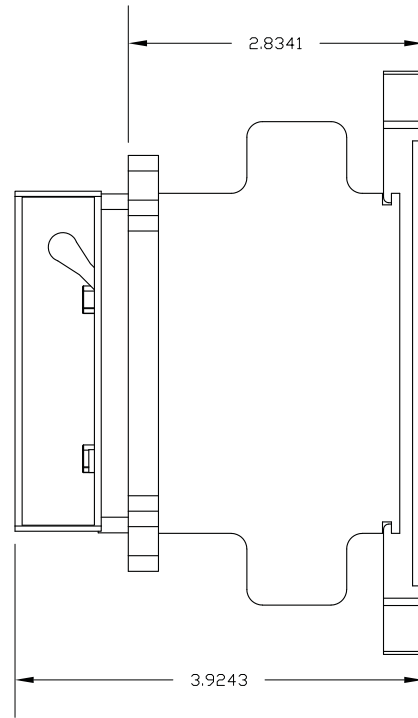
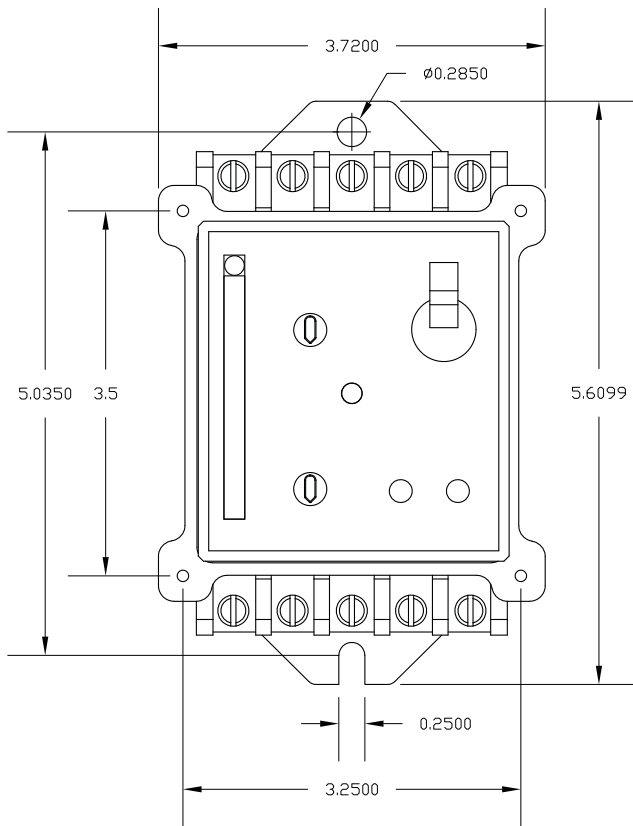

For additional information, see Bulletin 108, Revision 6

<http://www.boltswitch.com/pdf/108r6.pdf>